

Infrastructure creates opportunity for everyone

Uplifting communities, improving access and sustaining our planet

Whether it's improving your commute, keeping the lights on, providing access to clean water or transforming skylines, we believe infrastructure has the power to uplift people and communities.

We are the world's trusted infrastructure consulting firm — planners, designers, engineers, program and construction managers driven by a common purpose to deliver a better world.

On projects spanning transportation, buildings, water, energy and the environment, our public- and private-sector clients trust us to solve their most complex challenges.

Through our Think and Act Globally strategy we are focused on extending our industry-leading, global expertise to each of our projects around the world, transforming the way we deliver work through technology and digital platforms, and enhancing our position as a leading Environment, Social & Governance (ESG) company.

How we're delivering a better world

Creating sustainable legacies

We are leading the change towards a more sustainable and equitable future by partnering with our clients to provide solutions that help them achieve their environmental and social value ambitions and advancing sustainable business operations to help prevent the worst impacts of climate change.

Accelerating our industry's digital transformation

We are transforming how we work to drive faster results, smarter solutions and better outcomes. From pioneering digital design to developing innovative digital solutions that increase engagement and streamline processes, we bring the best minds together to solve our clients' biggest challenges.

Advancing equity, diversity and inclusion

When we feel free to be ourselves, we thrive. Equity, diversity and inclusion are core to our vision, and we are focused on taking action by bringing together a multitude of voices, ensuring that everyone is heard and cultivating equitable opportunities for all.

#1

Transportation, General Building and International Markets design firm, ENR-ranked

\$13.1B

Full-Year 2022 Professional Services Revenue (USD)

50K

Employees worldwide





California High-Speed Rail, United States

AECOM is delivering program management support for the nation's first dedicated high-speed rail system, which will provide frequent train service exceeding 200 miles per hour. The project is poised to become one of the most transformative infrastructure investments in U.S. history.



Ontario Line South, Canada

Serving on the Ontario Transit Group team, AECOM is providing design services to form part of the 15.6-kilometer, 15-stop Ontario Line rapid transit project intended to create faster, easier connections between dozens of Toronto neighborhoods.



JFK International Airport Terminal 1, United States

AECOM is helping enhance JFK International Airport's position as a premier, global aviation hub by providing design services on one of its largest international terminals.

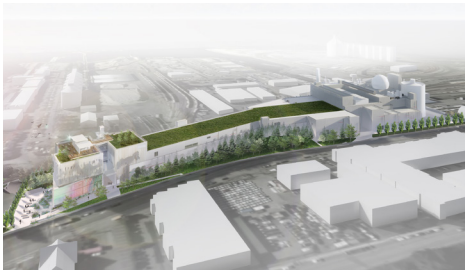

North Shore Water, Canada

AECOM is deepening client relationships to complete the design of the LEED Gold-certified treatment facility that will serve approximately 250,000 residents in the Vancouver area.



AIUla Programs, KSA

AECOM's program management team is implementing Phase 1 of the \$15-billion masterplan development that will accelerate regeneration in the core historical area of AIUla.



Northern Metropolis, Hong Kong

The Northern Metropolis is a megaproject that will transform the northern region of Hong Kong into a thriving metropolitan area of 2.5 million people. We're proud to deliver planning, engineering and civil infrastructure works across all phases of the project.



Melbourne Airport Rail, Australia

This new, 30-minute rail connection between Melbourne and Melbourne Airport will greatly enhance connectivity in and beyond Victoria, Australia. Our teams are providing an array of works for the project, which will provide direct access to the airport from more than 30 rail stations across Melbourne.



Network Rail Commercial Services Framework, UK

Our appointment to support Network Rail's operations in the UK through its Commercial Services framework continues AECOM's long-standing relationship with the region as we deliver technical, innovative and sustainable solutions to benefit both Network Rail and passengers.



Faro Mine Remediation Program, Canada

In partnership with the Government of Canada and affected First Nations, AECOM is delivering the Faro Mine Remediation program, which is one of the most complex abandoned mine clean-up projects in Canada.